

# EJS-GE-F2-SP

EXPANSION JOINT (F5583-10K)

Valveco®

epdm rubber bellow, flanged, 10k

## Technical Features

Design	JIS F 5583-10K
Face-to-Face Design	JIS F 5583-10K
Inlet Design	Flanged (JIS B 2210)
Outlet Design	Flanged (JIS B 2210)
Class	10K

## Options

- Other materials, flange connections and nominal sizes on request
- Vacuum ring
- Tie rods

## Dimensions

DN	Length	PCD	Holes	Holes Dia	Weight
(MM)	(MM)	(MM)	(#)	(MM)	(kg)
32	32	100	4	19 (M16)	
40	150	105	4	19 (M16)	3
50	150	120	4	19 (M16)	4
65	150	140	4	19 (M16)	5
80	150	150	8	19 (M16)	5
100	150	175	8	19 (M16)	6
125	150	210	8	23 (M20)	9
150	150	240	8	23 (M20)	12
200	150	290	12	23 (M20)	15
250	200	355	12	25 (M22)	24
300	200	400	16	25 (M22)	26

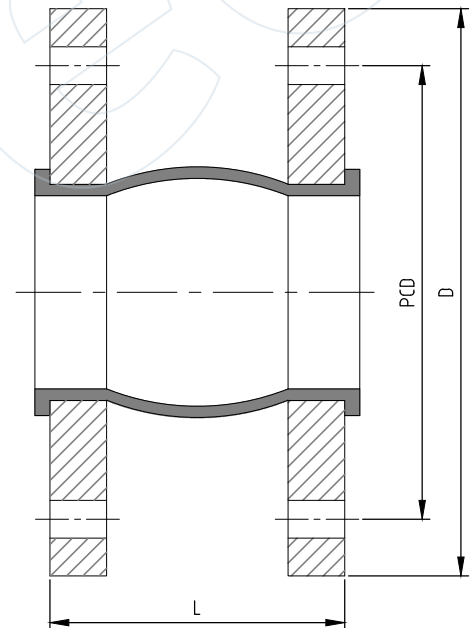

## Materials

Bellow	EPDM
Flange Material	Forged steel

All the product information presented on these pages is only indicative and is provided subject to typographical errors, changes and deviations. The buyer cannot derive any rights from this information. The seller excludes any liability for damage resulting from the use of this information.