

SFD-BF-SM

SAFETY VALVE

Valveco®

for compressed air, non flammable gases and vapors, open discharge type, vertical type, without lifting lever, male bspp

*commonly used on small air installations, air vessels

Technical Features

Class	PN40
Inlet Design	BSP (ISO 228 / DIN 259)

Dimensions

DN	Weight
(")	(kg)
1/4"	0.10
3/8"	0.14
1/2"	0.17
3/4"	0.35
1"	0.60
1 1/4"	0.97
1 1/2"	1.85
2"	2.45

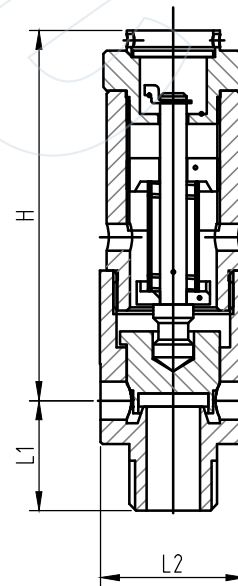

Materials

Body / Bonnet	Brass
Spring	Steel
Stem	Brass Ms 58
Gasket	Graphite
Disc	Brass
Body Seat Ring	FKM/PTFE

All the product information presented on these pages is only indicative and is provided subject to typographical errors, changes and deviations. The buyer cannot derive any rights from this information. The seller excludes any liability for damage resulting from the use of this information.