

# VHD-DS-F1

## AIR PIPE HEAD (FVENT)

Valveco®

vertical pattern, nodular cast iron body, stainless steel float, stainless steel float guide, 5k, flanged

### Technical Features

Class	5K
Inlet Design	Flanged (JIS B 2210)

### Dimensions

DN	PCD	Holes	Holes Dia	Weight
(MM)	(MM)	(#)	(MM)	(kg)
50	105	4	15 (M12)	11
65	130	4	15 (M12)	12
80	145	4	19 (M16)	17
100	165	8	19 (M16)	24
125	200	8	19 (M16)	31
150	230	8	19 (M16)	48
200	280	8	23 (M20)	67
250	345	12	23 (M20)	100
300	390	12	23 (M20)	135
350	435	12	25 (M22)	165
400	495	16	25 (M22)	195

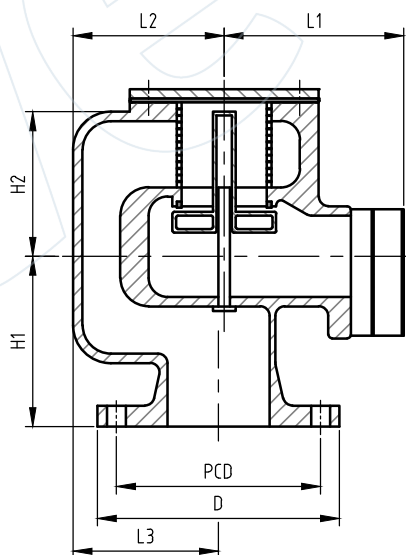

### Materials

Body	Nodular Cast Iron (JIS G 5502)
Disc	Stainless Steel (AISI 304)

All the product information presented on these pages is only indicative and is provided subject to typographical errors, changes and deviations. The buyer cannot derive any rights from this information. The seller excludes any liability for damage resulting from the use of this information.