

# EJS-GN-D2

## EXPANSION JOINT



nbr rubber bellow, pn10, flanged

### Technical Features

Class	PN10
Inlet Design	EN 1092 (DIN 2501)
Outlet Design	EN 1092 (DIN 2501)

### Options

- Other materials, flange connections and nominal sizes on request
- Vacuum ring
- Tie rods

\*\*\* Smaller sizes refer to data sheet EJS-GE-D3 \*\*\*

### Dimensions

DN	Length	PCD	Holes	Holes Dia	Weight
(MM)	(MM)	(MM)	(#)	(MM)	(kg)
200	130	295	8	22 (M20)	15
250	130	350	12	22 (M20)	20
300	130	400	12	22 (M20)	25
350	203	460	16	22 (M20)	43
400	203	515	16	26 (M24)	

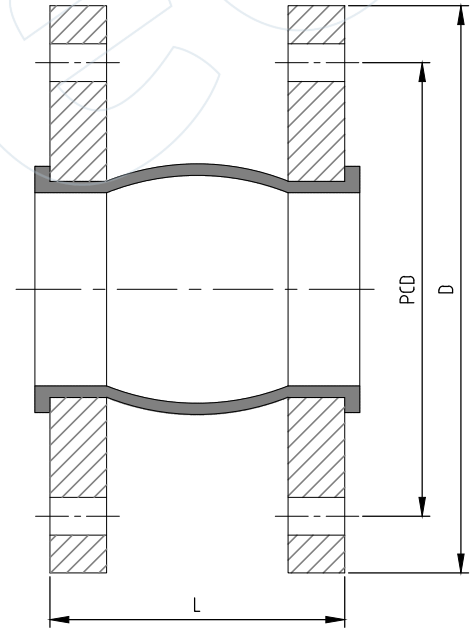

### Materials

Bellow	NBR
Flange Material	Forged steel

All the product information presented on these pages is only indicative and is provided subject to typographical errors, changes and deviations. The buyer cannot derive any rights from this information. The seller excludes any liability for damage resulting from the use of this information.